



Jindalee

Beachside Estate

STAGE 13



LEGEND

- Available Lots
- Previously Released
- Future Residential
- Brick Paving
- Footpath
- Side Entry Pit
- Water Connection
- Water Valve
- Water Hydra
- Diesel Meter
- DX Duplex Lot
- Future Crossover Location
- Subject to WAPC Condition
- Linesone
- Retaining Wall
- Drainage Wall
- Drainage Gate
- Power Dome and Connection
- Housing Connection
- Western Power Padmount Site
- Street Light & Steel Light Easement

All Dimensions and Areas are subject to survey. The particulars on this brochure are supplied for identification purposes only and shall not be taken as a representation in any aspect on the part of the vendor or its agents. Authorities should be consulted when services are contained within lot boundaries as building restrictions may apply. All retaining walls, services and associated easements are shown exaggerated for legibility. MNC Ref: 92322a-325a Date: 07/07/2020 © COPYRIGHT

Preliminary

Future Residential Development by others

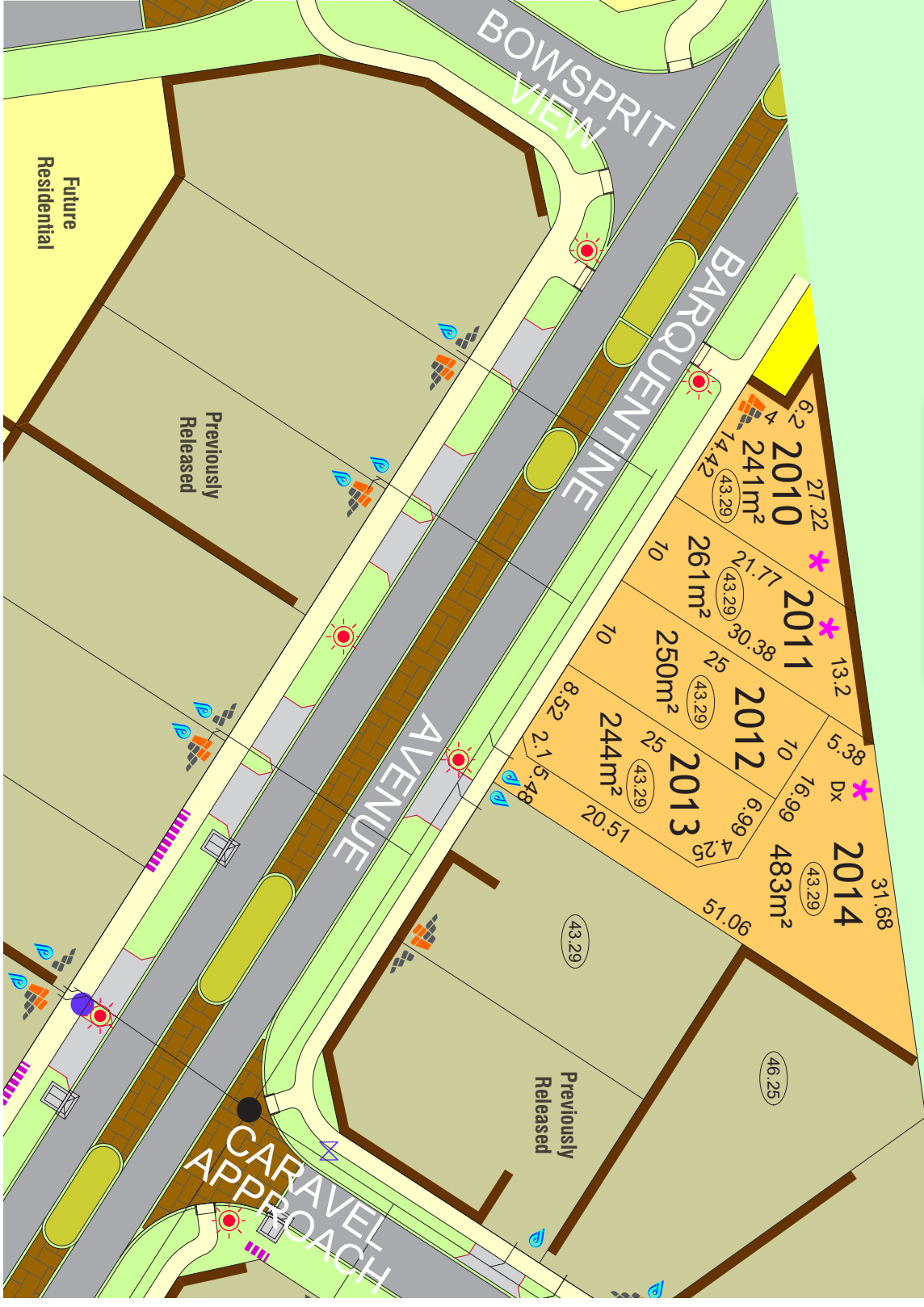

Steve Wilcox 0421 277 366

Harcourts Alliance

Harcourts Alliance
Phone: (08) 9300 3344
Email: steve.wilcox@harcourtsalliance.com.au
Web: www.harcourtsalliance.com.au